

The City of Livermore’s upcoming Vasco Road widening project:

Please visit our website for project updates at <https://www.cityoflivermore.net/government/community-development/engineering/project-information>

THANK YOU - The City of Livermore thanks the residents and roadway users for their patience and cooperation as we continue to develop the design and proceed into the construction phase.



The project will widen northbound Vasco Road from one lane to two lanes between Garaventa Ranch Road and Dalton Avenue to improve existing traffic operations and safety and provide bicyclist and pedestrian facilities.

Purpose And Need:

Congestion relief and bicyclist and pedestrian safety is the goal of the project. Vasco Road is a major arterial connecting Alameda County to Contra Costa County and the single lane in the northbound direction from Garaventa Ranch Road to Dalton Avenue is a major bottleneck during the afternoon commute. The high volume of trips over the hill into Brentwood constrain local residential trips. Out of necessity, commuters use local roads to bypass congestion in the area overloading adjacent residential streets introducing safety and noise concerns. By adding a travel lane in the northbound direction of Vasco Road will result in congestion relief. The bicycle facilities on Vasco, Garaventa and Dalton will provide safer crossing for bicyclist.

Bicycle Facilities - The project will include conversion of existing northbound and southbound Class II bike lanes to Class IV separated bikeways with 2’ buffers and 5’ lane widths consistent with the City’s Bicycle, Pedestrian and Trails Active Transportation Plan. Landscaping along the new bicycle facilities on the eastbound lane will provide shade to pedestrians and bicyclists. The project will also provide a Class IV bikeway in the eastbound direction and a Class II bikeway in the westbound direction on Dalton Avenue from Pasatiempo St to Vasco Road.

Stormwater Facilities - The project will also install permanent stormwater treatment measures consistent with Provision C.3 of the Alameda Countywide Clean Water Program.

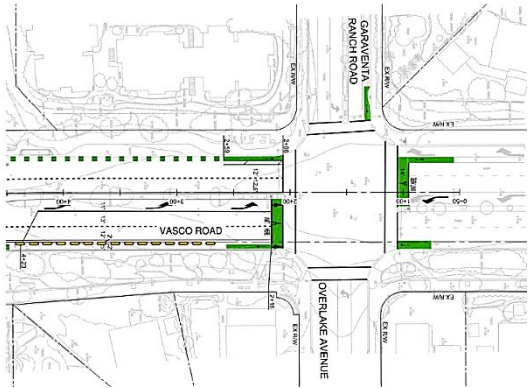
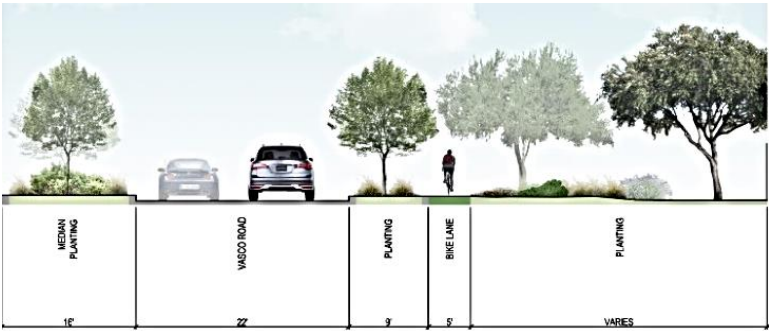
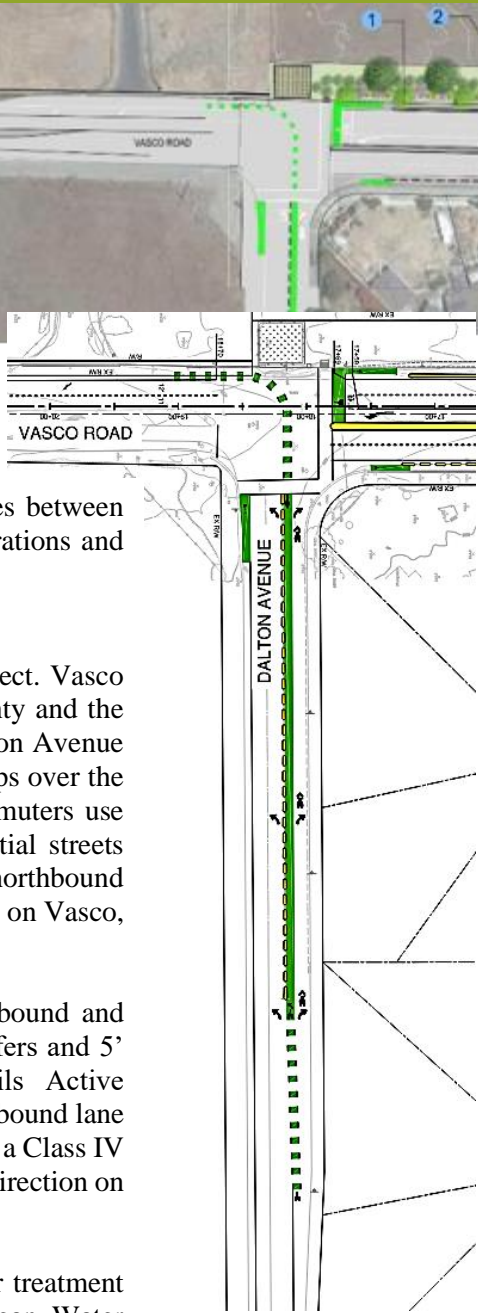

BIOTREATMENT PLANTING



DROUGHT TOLERANT PLANTING SCHEME

TREES

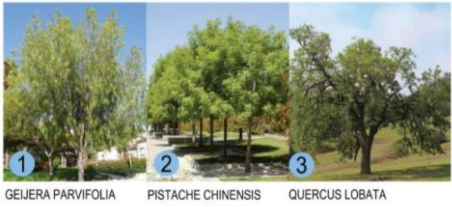

GROUND COVER



SHRUBS



PLEASE FEEL FREE TO CONTACT THE CITY WITH ANY QUESTIONS:

City of Livermore, Community Development Department
Mallika Ramachandran, P.E, QSD/QSP, LEED A.P. Assistant City Engineer
Phone: (925) 960-4511
Email: mramachandran@livermoreca.gov

- City’s Project Manager: Mallika Ramachandran, P.E
- Consultant: HMM Engineers.
- Current Phase: 65% Design and Environmental Review
- Tentative Construction Schedule (contingent upon regulatory permits): summer 2024
- Funding: Traffic Impact Fees
- Estimated Construction Cost: \$3 Million